

Hydraulic pump **HY35A/B**

Technical specifications:

Model:	A	B
Capacity:	100-120 m ³ /h	140-170 m ³ /h
Head:	20-28 m	14-20 m
Weight:	500 Kg	515 Kg
Cross section:	ø 35 mm	ø 35 mm
Impeller:	3 vanes closed / ø 435 mm	3 vanes closed / ø 435 mm
Bore:	ø 100 mm	ø 150 mm

Motor:

Speed:	980-1180 R.P.M.	980-1180 R.P.M.
Output:	18.5-26 kW (25-35 HP)	18.5-26 kW (25-35 HP)
Need of oil:	54-65 L/min.	54-65 L/min.
Oil pressure:	210-250 bar	210-250 bar
Motor displacement:	55 c.c.	55 c.c.

Materials:

Main Body: spheroidal cast iron GS500.
 Motor Housing: cast iron G25.
 Wearing parts: high chrom.
 Main Shaft: austempering NiCrMo4 Steel.

Seals:

Seals motor zone: n°2 rubber lip seals.
 Seals impeller zone: n°1 polyuretane V-RING n°3 rubber lip seals n°2 PTFE lip seals with stainless steel spring (alternate).

Performance Curve

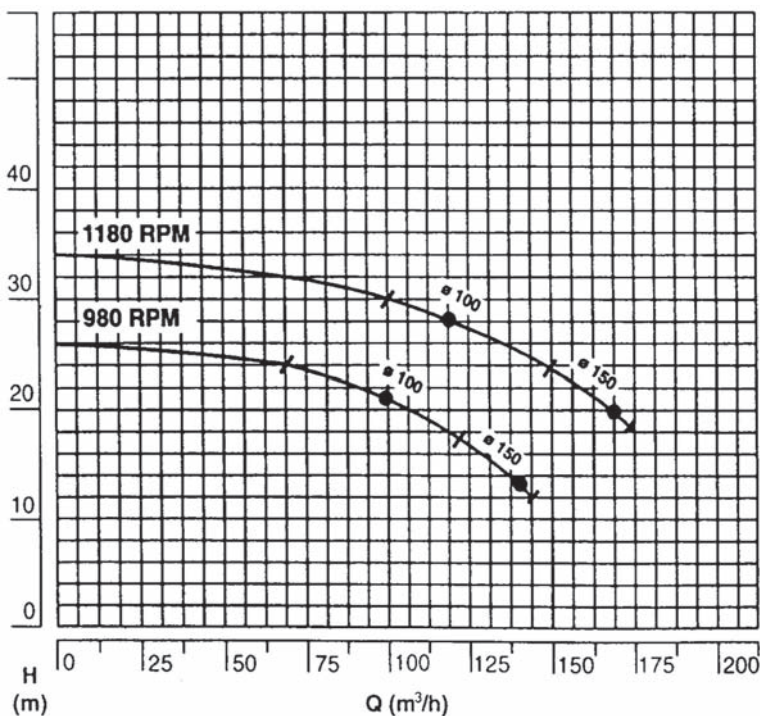

Dimensions

A (mm)	1210
B (mm)	420
C (mm)	540
D (mm)	667
E (mm)	323
F (mm)	327
G (mm)	380
H1 (mm)	270
H2 (mm)	145
I (mm)	818

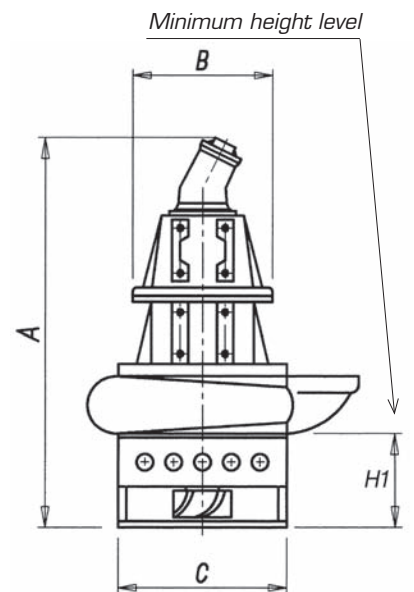
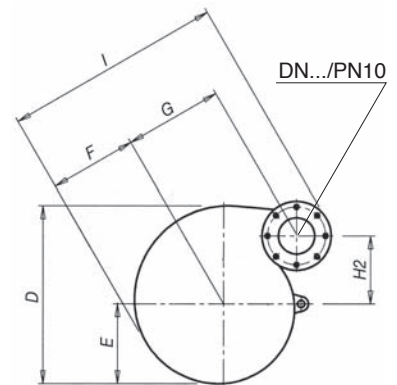

Hydraulic pump **HY50-108A/B**

Technical specifications:		
Model:	A	B
Capacity:	100 m ³ /h	200 m ³ /h
Head:	63 m	48 m
Weight:	600 Kg	620 Kg
Cross section:	Ø 35 mm	Ø 35 mm
Impeller:	2 vanes closed / Ø 490 mm	2 vanes closed / Ø 490 mm
Bore:	Ø 100mm	Ø 150 mm

Motor:		
Speed:	1450 rpm	1450 rpm
Output:	64 kW (85 HP)	64 kW (85 HP)
Need of oil:	160 L/min	160 L/min
Oil pressure:	250 bar	250 bar
Motor displacement:	108 c.c.	108 c.c.

Materials:
 Main body: spheroidal cast iron GS500.
 Motor housing: cast iron GS5.
 Wearing parts: high chrom.
 Main shaft: austempering NiCrMo4 Steel.

Seals:
 Seals motor zone: n° 2 rubber lip seals.
 Seals impeller zone: n° 1 polyuretane V-RING, n° 1 COMBY lip seal, n° 2 box double lip seals.



Performance curves:

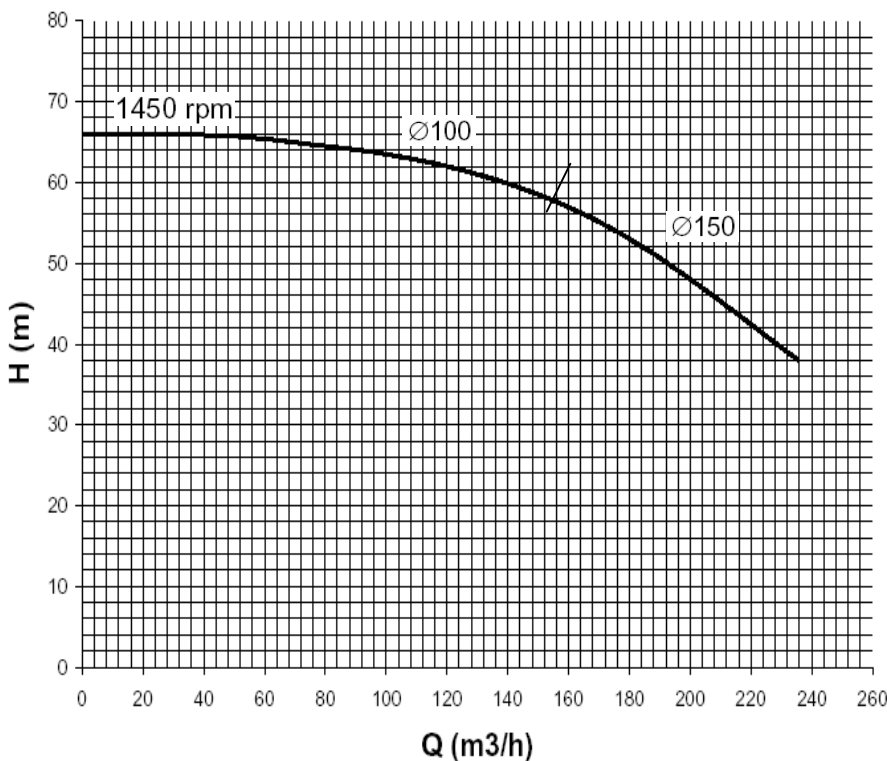

Dimensions:

A (mm)	1330
B (mm)	460
C (mm)	600
D (mm)	774
E (mm)	363
F (mm)	374
G (mm)	418
H1 (mm)	270
H2 (mm)	298
I (mm)	902

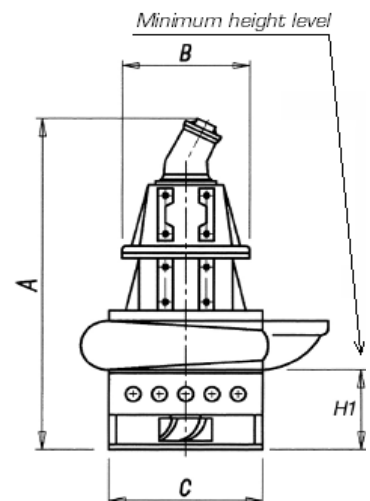
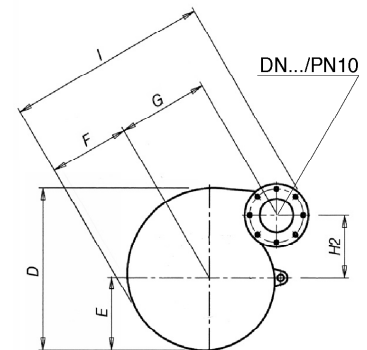

Hydraulic pump **HY50A/B**

Technical specifications:

Model:	A	B
Capacity:	90-108 m ³ /h	140-170 m ³ /h
Head:	30-42 m	22-32 m
Weight:	600 Kg	615 Kg
Cross section:	ø 35 mm	ø 35 mm
Impeller:	2 vani chiusa / ø 490 mm	2 vani chiusa / ø 490 mm
Bore:	ø 100 mm	ø 150 mm

Motor:

Speed:	980-1180 R.P.M.	980-1180 R.P.M.
Output:	26-37 kW (35-50 HP)	26-37 kW (35-50 HP)
Need of oil:	74-89 L/min.	74-89 L/min.
Oil pressure:	210-250 bar	210-250 bar
Motor displacement:	75 c.c.	75 c.c.

Materiali:

Main Body: spheroidal cast iron GS500.
 Motor Housing: cast iron G25.
 Wearing parts: high chrom.
 Main Shaft: austempering NiCrMo4 Steel.

Seals:

Seals motor zone: n°2 rubber lip seals.
 Seals impeller zone: n°1 polyuretane V-RING n°1 COMBY lip seal n°2 box duple lip seals.

Performance Curve

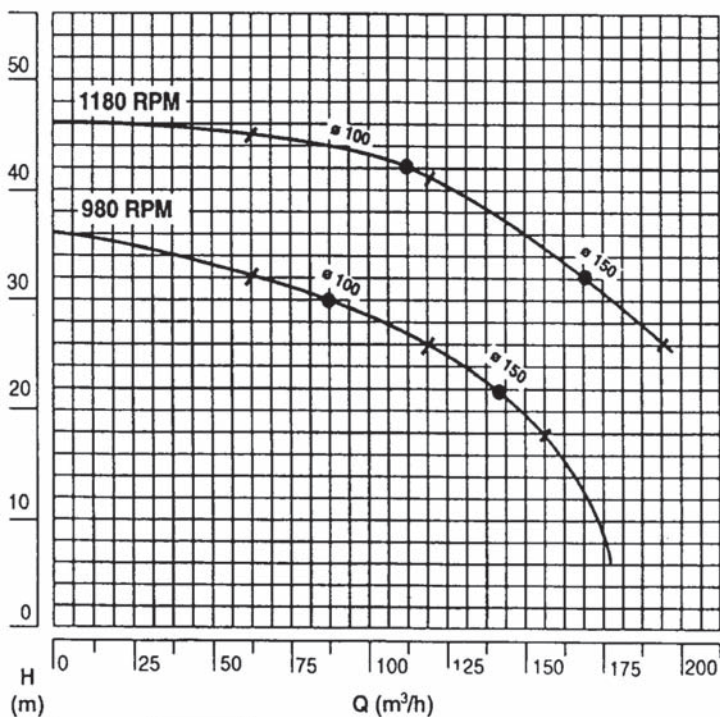

Dimensions

A (mm)	1330
B (mm)	460
C (mm)	600
D (mm)	774
E (mm)	363
F (mm)	374
G (mm)	418
H1 (mm)	270
H2 (mm)	298
I (mm)	902

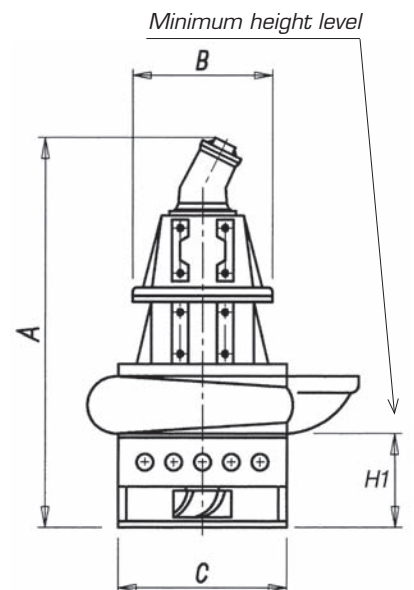
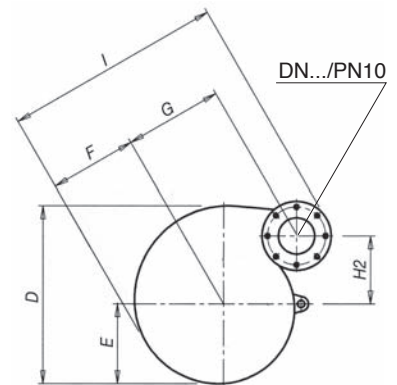

Hydraulic pump **HY50HC**

Technical specifications:

Capacity:	210 m ³ /h	250 m ³ /h
Head:	15 m	21 m
Weight:	700 Kg	700 Kg
Cross section:	ø 60 mm	ø 60 mm
Impeller:	2 vanes closed / ø 380 mm	2 vanes closed / ø 380 mm
Bore:	ø 150 mm	ø 150 mm

Motor:

Speed:	980 R.P.M.	1180 R.P.M.
Output:	26 kW (35 HP)	37 kW (50 HP)
Need of oil:	74 L/min.	89 L/min.
Oil pressure:	210 bar	250 bar
Motor displacement:	75 c.c.	75 c.c.

Materiali:

Main Body: spheroidal cast iron GS500.
 Motor Housing: cast iron G25.
 Wearing parts: high chrom.
 Main Shaft: austempering NiCrMo4 Steel.

Seals:

Seals motor zone: n°2 rubber lip seals.
 Seals impeller zone: n°1 polyuretane V-RING n°3 rubber lip seals n°2 PTFE lip seals with stainless steel spring (alternate).

Performance Curve

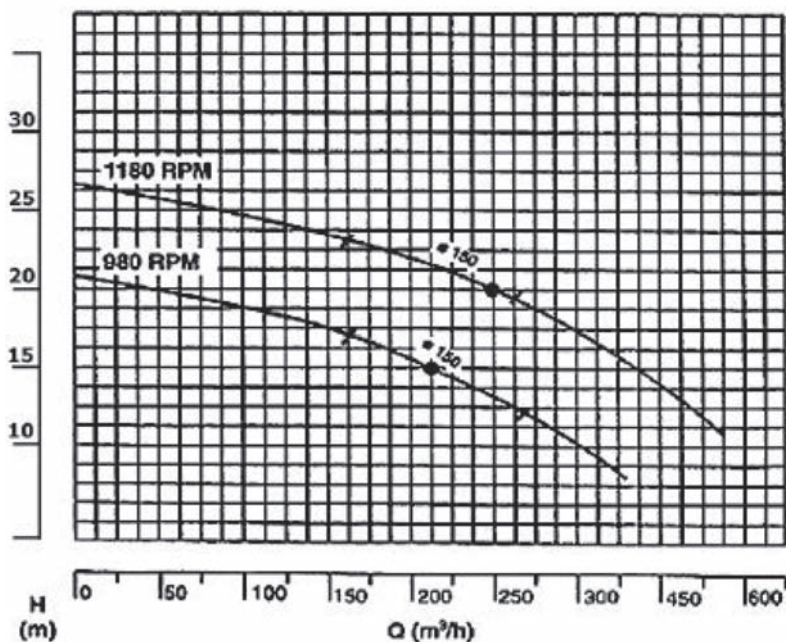

Dimensions

A (mm)	1425
B (mm)	460
C (mm)	540
D (mm)	736
E (mm)	334
F (mm)	350
G (mm)	412
H1 (mm)	270
H2 (mm)	282
I (mm)	902

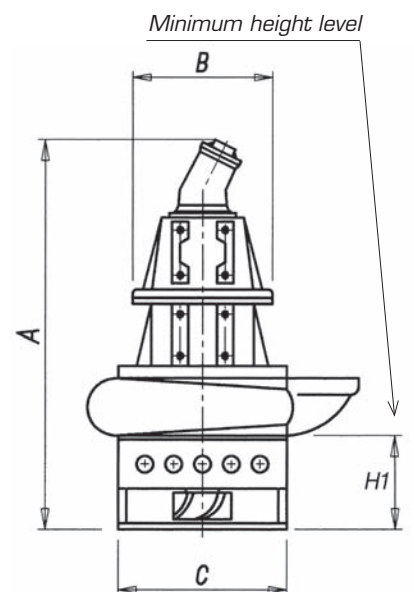
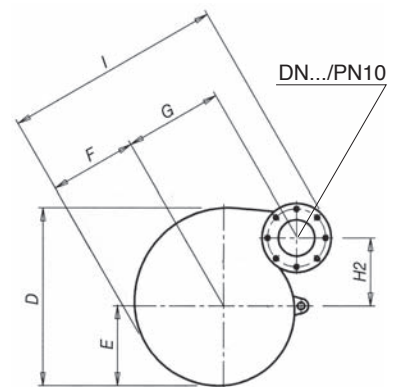

Hydraulic pump **HY85/160**



Technical specifications:

Model:	A	B
Capacity:	250 m ³ /h	500 m ³ /h
Head:	51 m	36 m
Weight:	820 Kg	840 Kg
Cross section:	Ø 60 mm	Ø 60 mm
Impeller:	3 vaned closed / Ø 440 mm	3 vaned closed / Ø 440 mm
Bore:	Ø 200 mm	Ø 250 mm

Motor:

Speed:	1450 rpm	1450 rpm
Output:	115 Kw (156 HP)	115 Kw (156 HP)
Need of oil:	240 L/min	240 L/min
Oil pressure:	300 bar	300 bar
Motor displacement:	160 c. c.	160 c. c.

Materials:

Main body: spheroidal cast iron GS500.
 Motor housing: cast iron GS5.
 Wearing parts: high chrom.
 Main shaft: austempering NiCrMo4 Steel.

Seals:

Seals motor zone: n° 2 rubber lip seals.
 Seals impeller zone: n° 1 polyuretane V-RING, n° 3 rubber lip seals, n° 2 PTFE lip seals with stainless steel spring (alternate).

Performance curve:

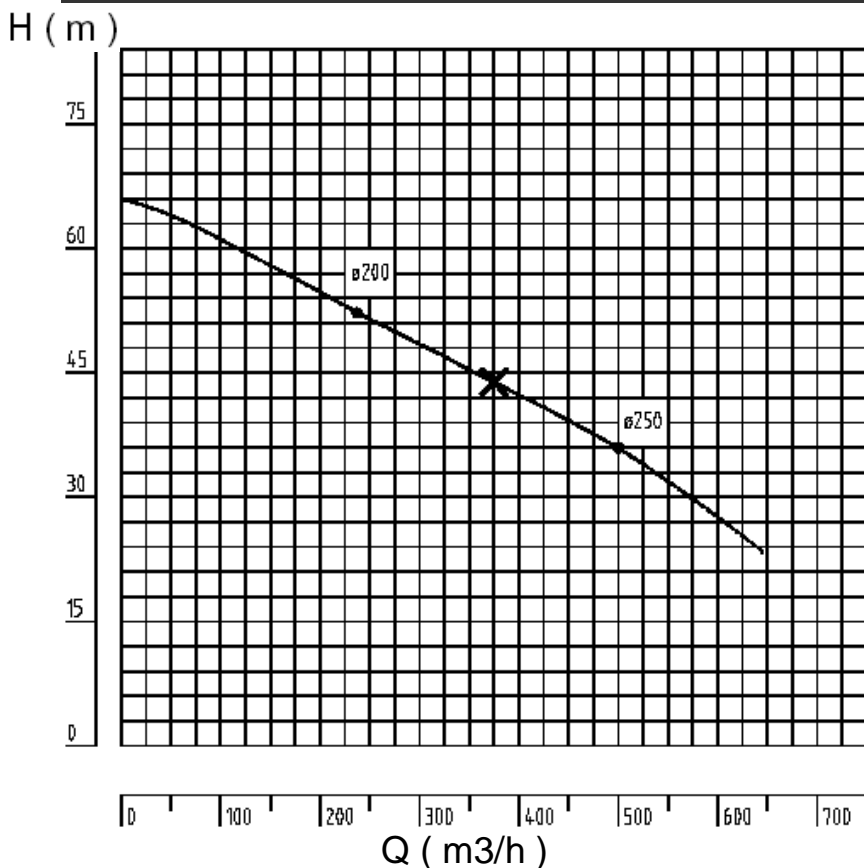

Dimensions:

A (mm)	1390
B (mm)	460
C (mm)	548
D (mm)	747
E (mm)	334
F (mm)	362
G (mm)	428
H1 (mm)	290
H2 (mm)	197
I (mm)	933

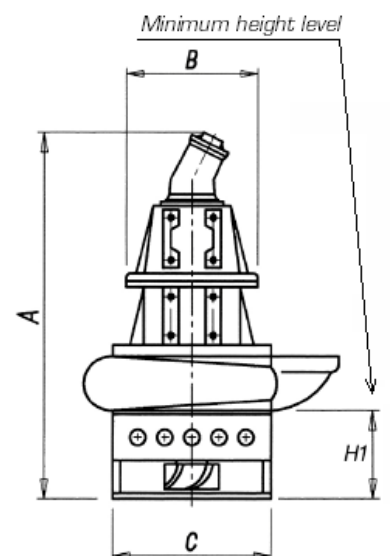
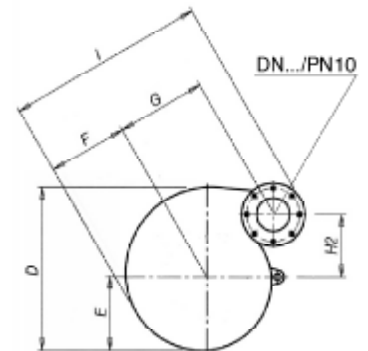

Hydraulic pump **HY85/160HC**

Technical specifications:

Model:	
Capacity:	800 m ³ /h
Hrad:	18 m
Weight:	1100 Kg
Cross section:	Ø 90 mm
Impeller:	2 vanes closed / Ø 405 mm
Bore:	Ø 250 mm

Motor:

Speed:	1450 rpm
Output:	115 kW (156 HP)
Need of oil:	240 L/min
Oil pressure:	300 bar
Motor displacement:	160 c.c.

Materials:

Main body: spheroidal cast iron GS500.
 Motor housing: cast iron GS5.
 Wearing parts: high chrom.
 Main shaft: austempering NiCrMo4 Steel.

Seals:

Seals motor zone: n° 2 rubber lip seals.
 Seals impeller zone: n° 1 polyuretane V-RING, n° 3 rubber lip seals, n° 2 PTFE lip seals with stainless steel spring (alternate).



Performance curves:

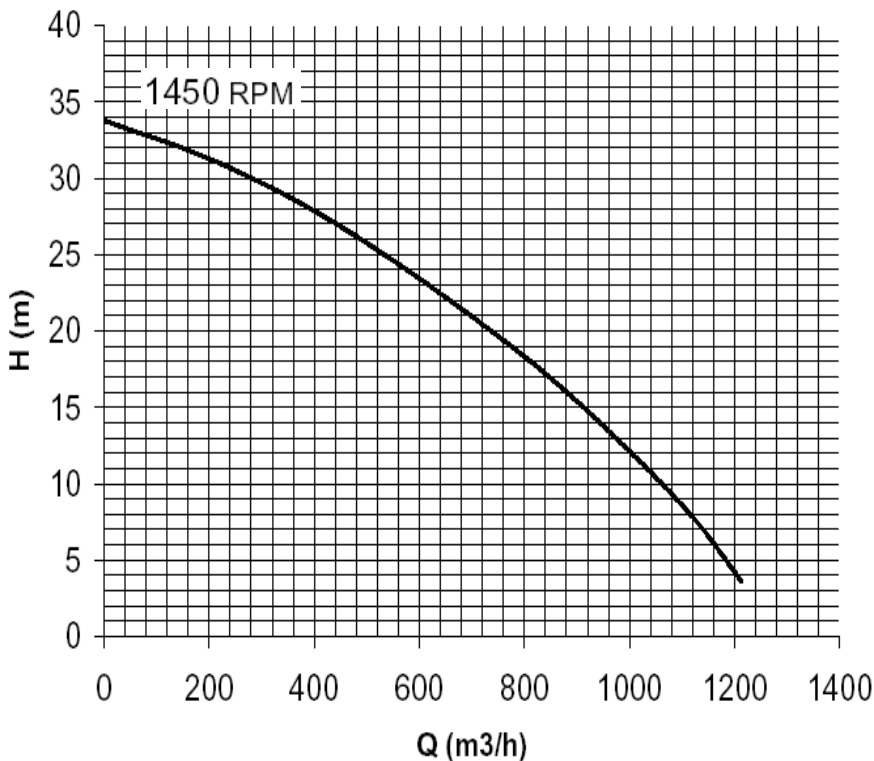

Dimensions:

A (mm)	1470
B (mm)	460
C (mm)	548
D (mm)	1020
E (mm)	449
F (mm)	478
G (mm)	485
H1 (mm)	326
H2 (mm)	340
I (mm)	1165

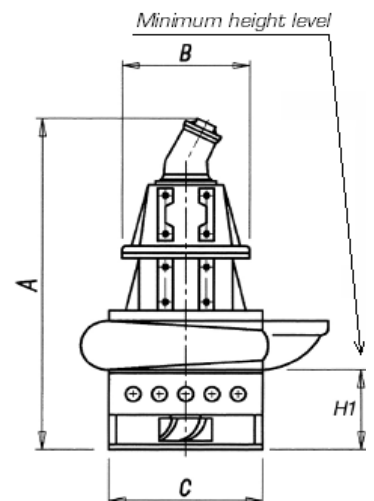
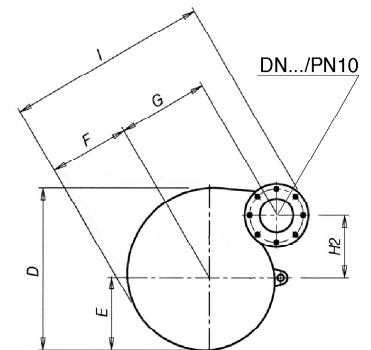

Hydraulic pump **HY85HC**

Technical specifications:

Capacity:	720 m ³ /h	860 m ³ /h
Head:	5 m	7 m
Weight:	1000 Kg	1000 Kg
Cross section:	ø 90 mm	ø 90 mm
Impeller:	3 vanes closed / ø 405 mm	3 vanes closed / ø 405 mm
Bore:	ø 250 mm	ø 250 mm

Motor:

Speed:	980 R.P.M.	1180 R.P.M.
Output:	44 kW (60 HP)	62 kW (85 HP)
Need of oil:	106 L/min.	130 L/min.
Oil pressure:	250 bar	300 bar
Motor displacement:	108 c.c.	108 c.c.

Materiali:

Main Body: spheroidal cast iron GS500.
 Motor Housing: cast iron G25.
 Wearing parts: high chrom.
 Main Shaft: austempering NiCrMo4 Steel.

Seals:

Seals motor zone: n°2 rubber lip seals.
 Seals impeller zone: n°1 polyuretane V-RING n°3 rubber lip seals n°2 PTFE lip seals with stainless steel spring (alternate).

Performance Curve

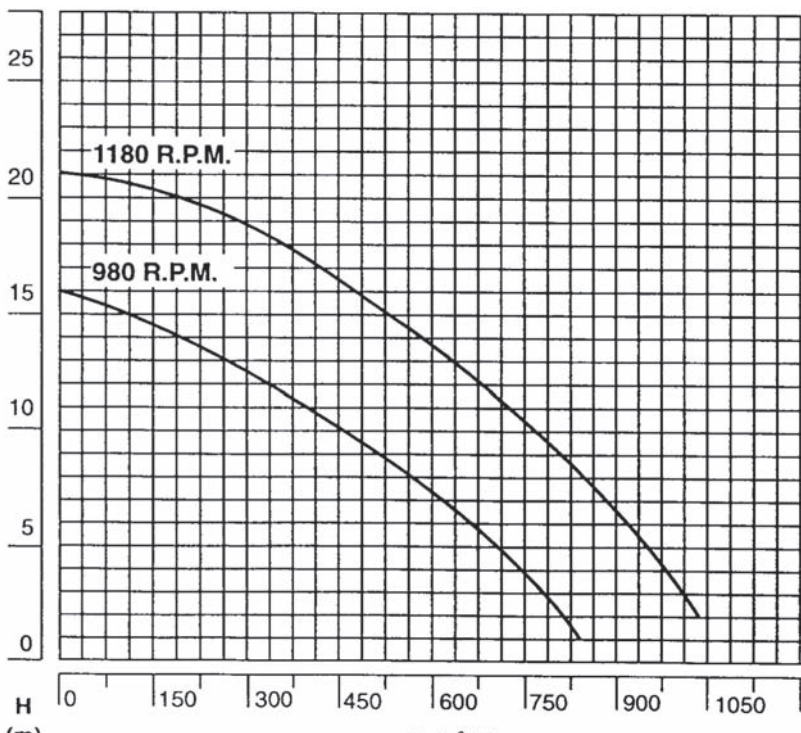

Dimensions

A (mm)	1470
B (mm)	460
C (mm)	548
D (mm)	1020
E (mm)	449
F (mm)	478
G (mm)	485
H1 (mm)	326
H2 (mm)	340
I (mm)	1165

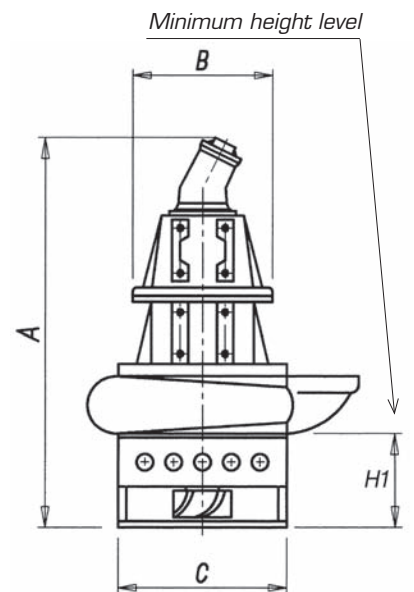
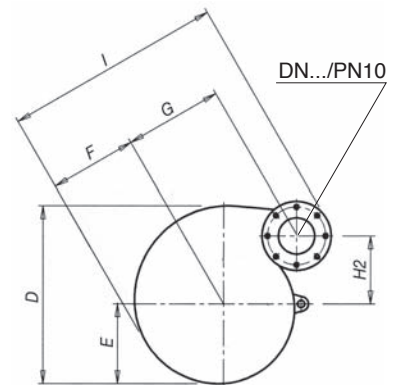

Hydraulic pump

HY85A/B



PUMP SPECIFICATIONS	Mod. A	Mod. B
Capacity [m ³ /h - (USGPM)]	240 - (1056)	360 - (1585)
Head [m - (ft)]	37 - (122)	33 - (109)
Impeller diameter [mm - (in)]/type	440 - (17.6)/3 blades closed	
Flanged bore size [DN.../PN... - (in)]	DN150/PN10 - (6)	DN200/PN10 - (8)
Cross section diameter [mm - (in)]	60 - (2.4)	
Weight [kg - (lbs)]	700 - (1540)	730 - (1606)

HYDRAULIC MOTOR	
Motor displacement [cc - (cu in)]	108 - (6.5)
Max. oil flow rate[l/min - (USGPM)]	130 - (34)
Max. pressure [bar - (psi)]	300 - (4350)
Power [kW-HP]	65-90
Speed [RPM]	1180

MATERIALS	
Casing	Spheroidal cast iron EN-GJS-500-7 (EN 1563)
Motor housing	Cast iron EN-GJL-250 (EN 1561)
Wear parts	High chrome EN-GJN-HV600 (XCr18) (EN 12513)
Main shaft	High tensile steel 39NiCrMo3 (AISI 9840)

SEALS / LUBRICANT	
Motor side seals	2 lip seals (BUNA)
Impeller side seals	5 lip seals (3 BUNA + 2 PTFE) + 1 V-RING (TPU)
Oil type	ISO 320

DIMENSIONS [mm - (in)]							
H	W	D	F	H1	A	B	C
1390	933	747	548	290	362	428	334
(55.6)	(37.3)	(29.9)	(21.9)	(11.6)	(14.5)	(17.1)	(13.4)

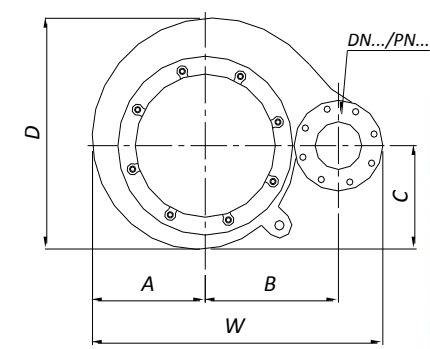
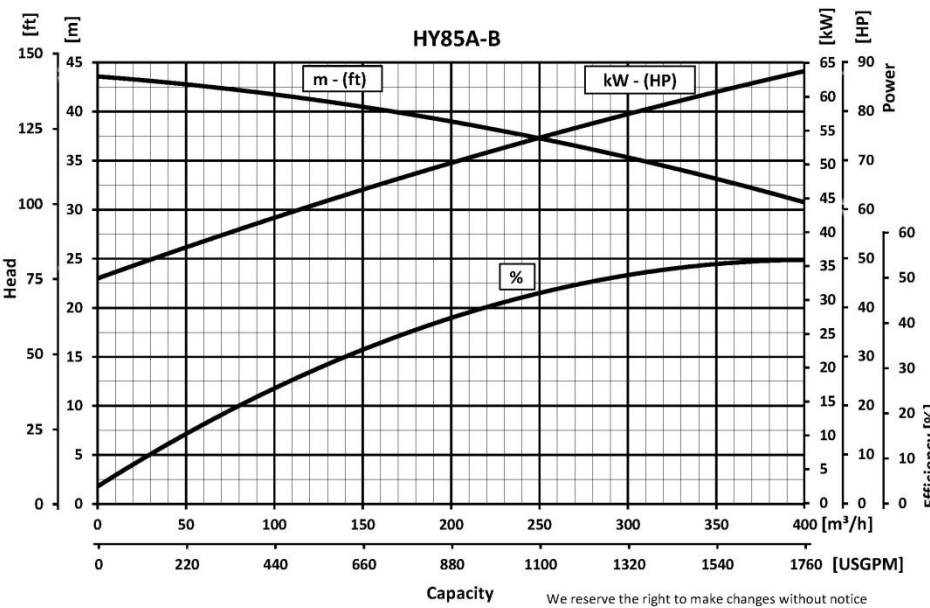
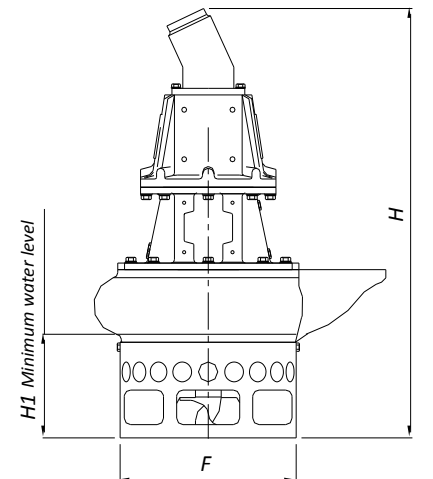

Hydraulic pump

HY85A/B



PUMP SPECIFICATIONS	Mod. A	Mod. B
Capacity [m ³ /h]	240	360
Head [m]	37	33
Impeller diameter [mm]/type	440/3 blades closed	
Flanged bore size [DN.../PN...]	DN150/PN10	DN200/PN10
Cross section diameter [mm]	60	
Weight [kg]	700	730

HYDRAULIC MOTOR	
Motor displacement [cc]	108
Max. oil flow rate[l/min]	130
Max. pressure [bar]	300
Power [kW-HP]	65-90
Speed [RPM]	1180

MATERIALS	
Casing	Spheroidal cast iron EN-GJS-500-7 (EN 1563)
Motor housing	Cast iron EN-GJL-250 (EN 1561)
Wear parts	High chrome EN-GJN-HV600 (XCr18) (EN 12513)
Main shaft	High tensile steel 39NiCrMo3 (AISI 9840)

SEALS / LUBRICANT	
Motor side seals	2 lip seals (BUNA)
Impeller side seals	5 lip seals (3 BUNA + 2 PTFE) + 1 V-RING (TPU)
Oil type	ISO 320

DIMENSIONS [mm]							
H	W	D	F	H1	A	B	C
1390	933	747	548	290	362	428	334

PERFORMANCE CURVES

